

COURTCARE

SQUASH COURT LAYOUT

and installation sequence
for traditionally-constructed courts



Armourcoat playline & plaster detail

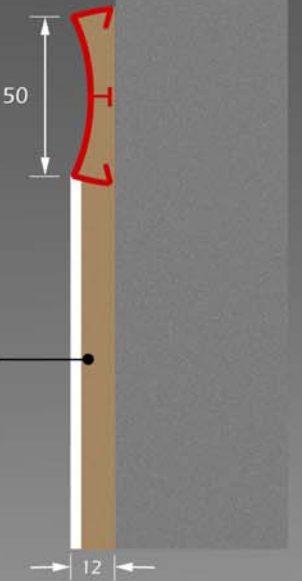

The Armourcoat 'Tin'

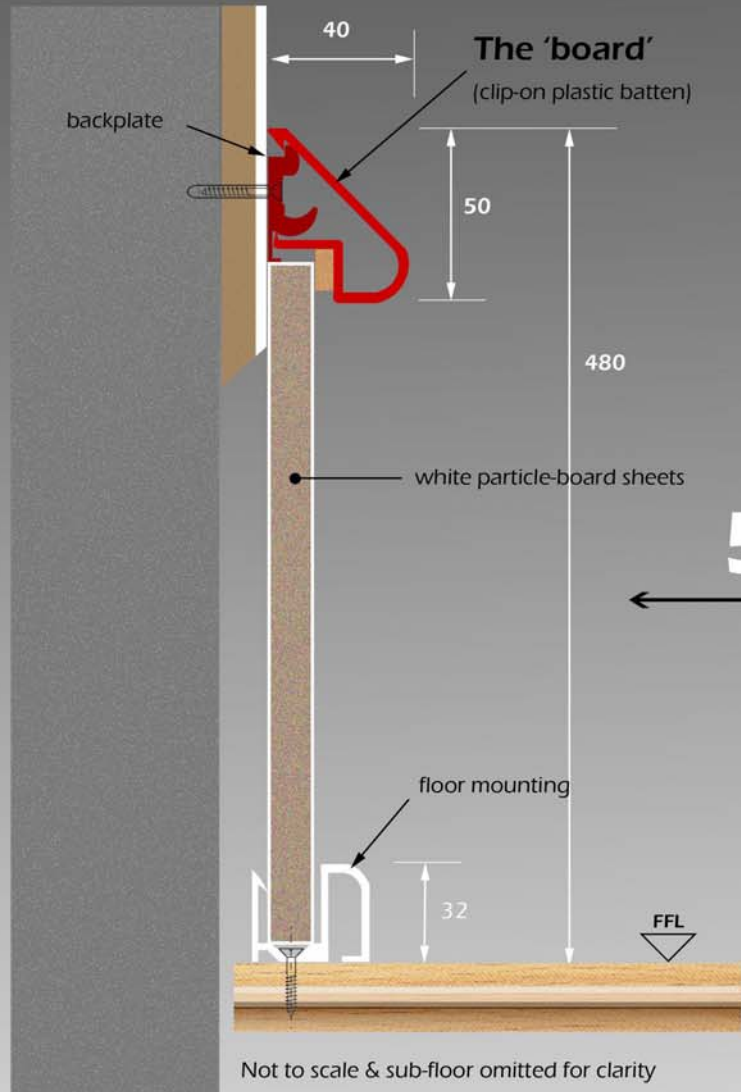

left-hand wall omitted for clarity

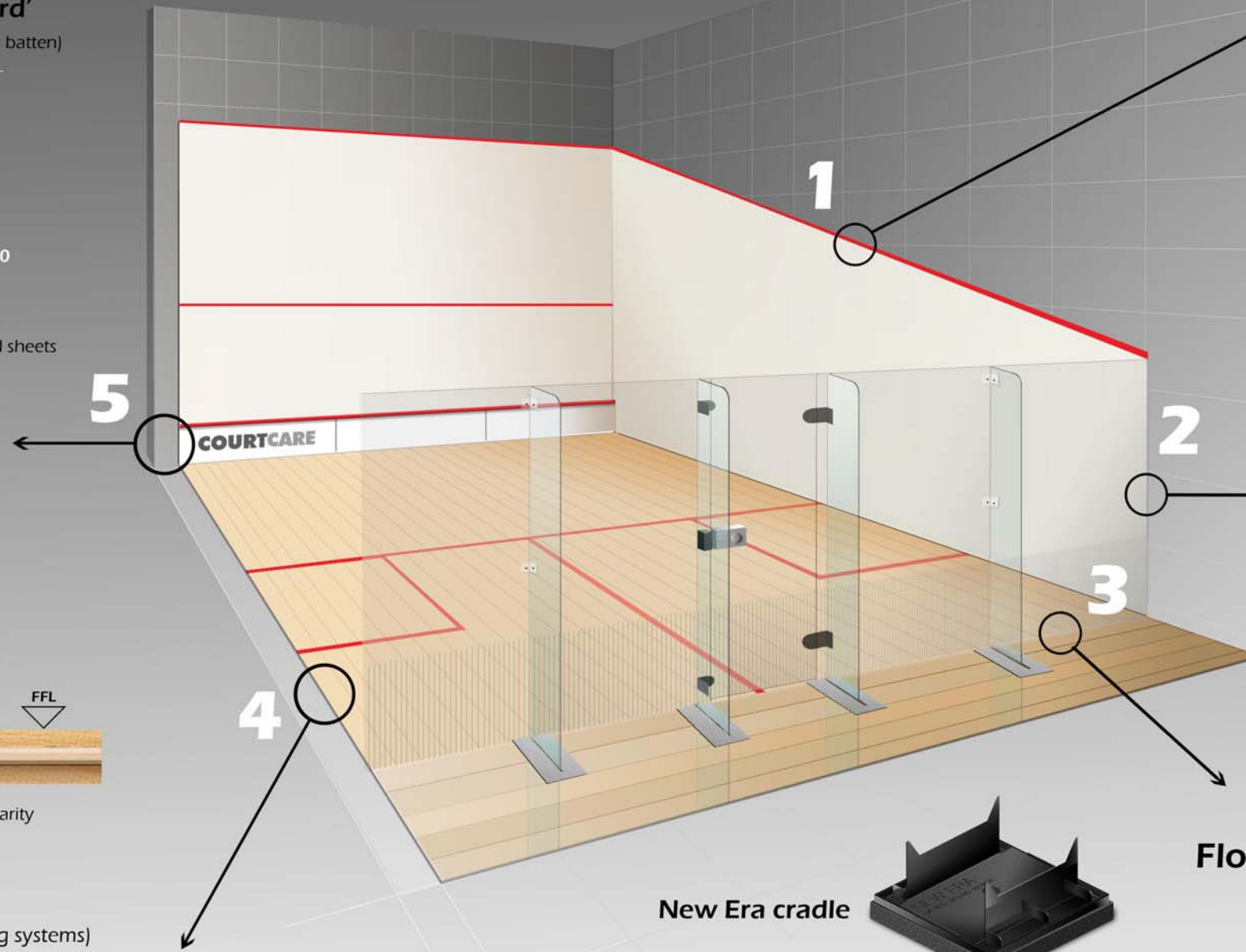

Sidewall glass detail

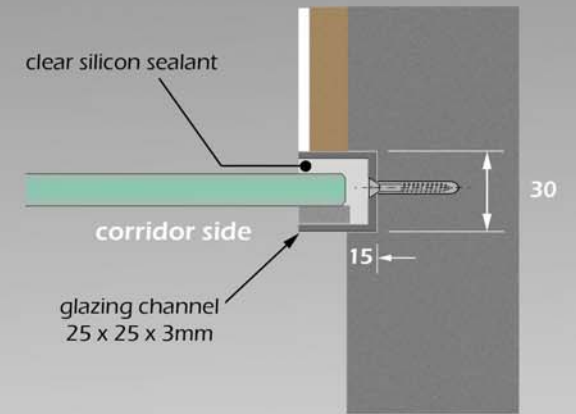

Ellis Pearson glass wall

Floor/ glasswall detail

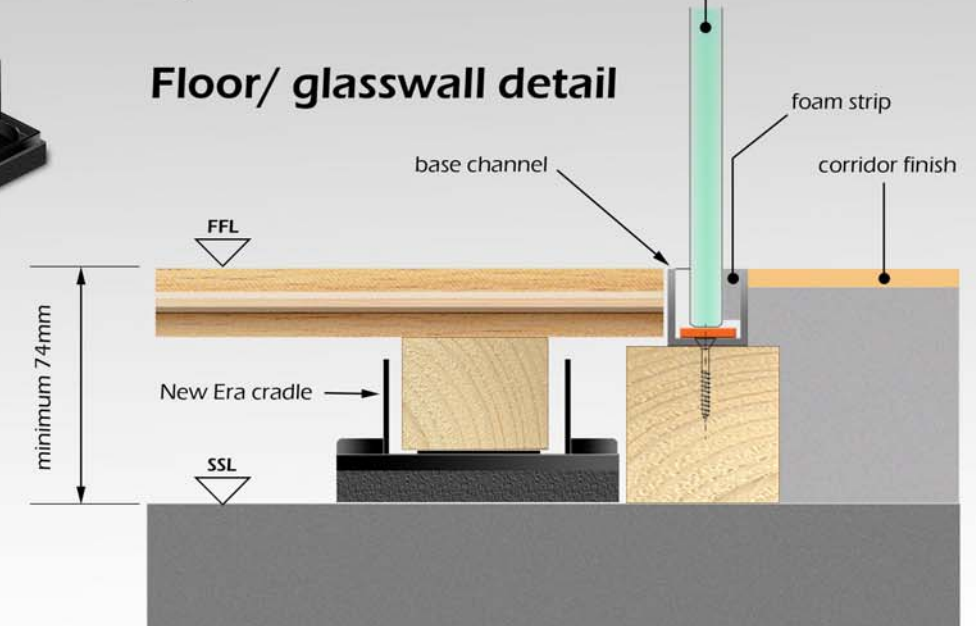

Floor details

(illustrations based on Junckers SylvaSquash flooring systems)

single-batten system complies with BS EN 14904 type A3



cradle system complies with BS EN 14904 type A4



New Era cradle

